



14 THE MEADOWS

AYLESBURY, HP22 4TL

£575,000
FREEHOLD

An immaculately presented four bedroom detached house in the popular village of Whitchurch. Set in a quiet cul de sac and chain free, this property benefits from - multiple reception rooms - en suite & family bathroom - double garage & driveway. Viewing is highly advised on this beautiful home.



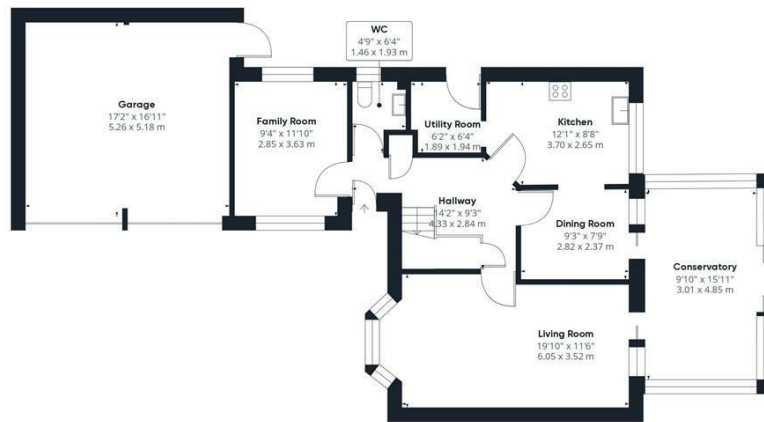

Ground Floor



Floor 1

Approximate total area⁸¹
1649.25 ft²
153.22 m²

(1) Excluding balconies and terraces

While every attempt has been made to ensure accuracy, all measurements are approximate, not to scale. This floor plan is for illustrative purposes only.

Calculations are based on RICS IPMS 3C standard.

GIRAFFE360

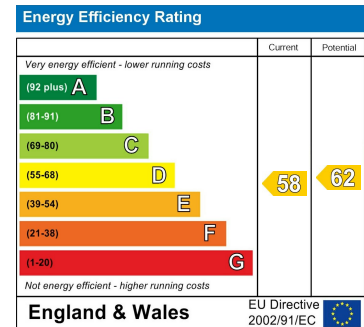

Agents Note: Whilst every care has been taken to prepare these particulars, they are for guidance purposes only. All measurements are approximate and are for general guidance purposes only and whilst every care has been taken to ensure their accuracy, they should not be relied upon and potential buyers/tenants are advised to recheck the measurements

George David & Co
46 High Street
Aylesbury
HP20 1SE

01296 393 393
info@georgedavid.co.uk
www.georgedavid.co.uk

